

# ROHMANN Moving Coil Cartridge

ortofon  
accuracy in sound

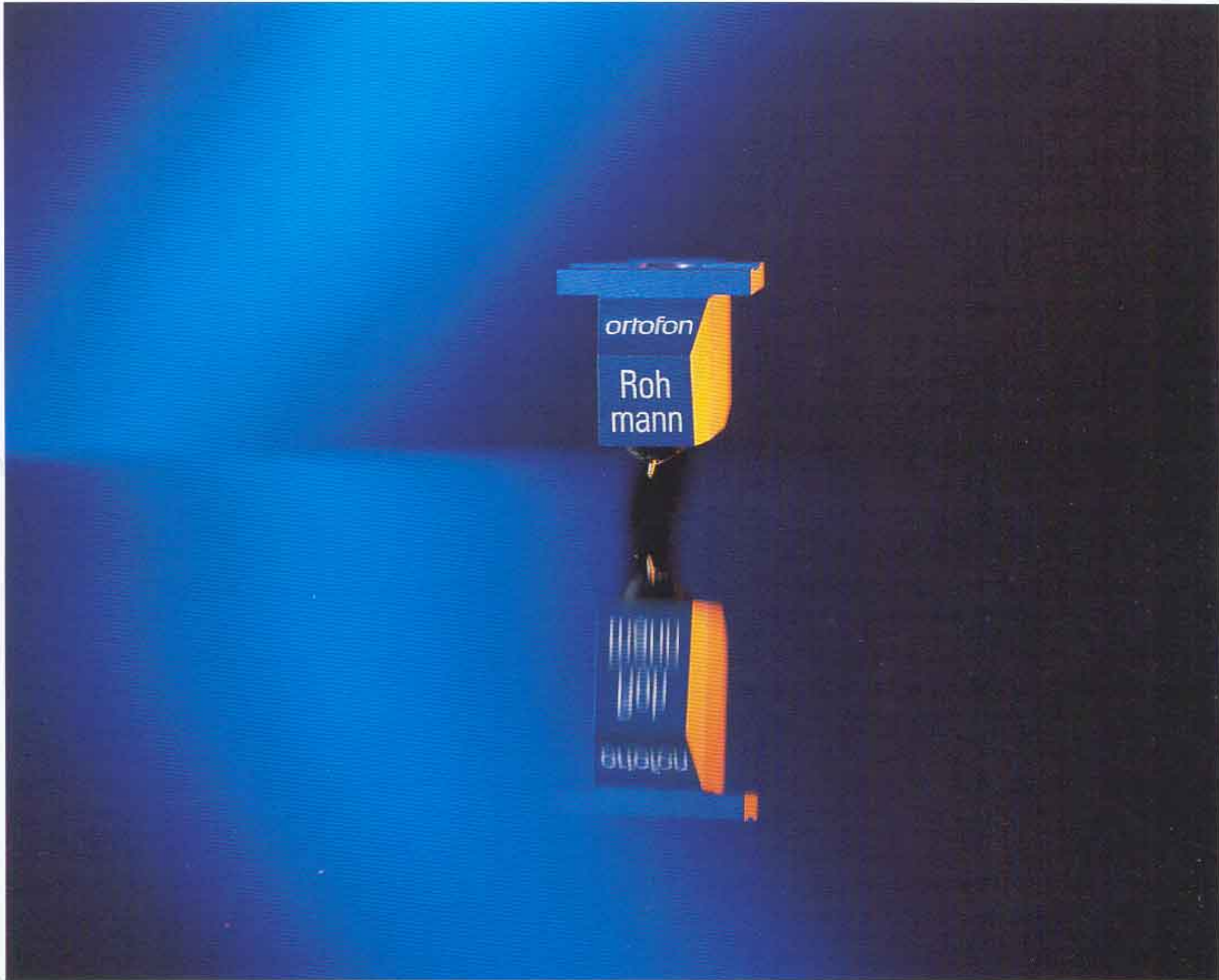

In honour of our late president and owner we have decided that this new and very fine moving coil cartridge shall be graced with the name "ROHMANN".

Erik Rohmann started with Ortofon in 1970 and gained control and ownership in 1980. Throughout these 25 years he has led Ortofon with a passion and dedication second to none, expressing great loyalty to our staff and the true analogue sound we present.

Ortofon introduced the world's first moving coil cartridge as far back as 1948. And ever since, the moving coil principle has been recognised as the finest reproduction form for analogue sound. Throughout the years Ortofon has developed many new cartridges, refining the moving coil principle through patented systems and techniques. When you choose an Ortofon moving coil cartridge, you can be assured of the most advanced technology, and the best sound:

# ROHMANN Moving Coil Cartridge

**ortofon**  
accuracy in sound

## The Stylus

The new Rohmann cartridge has been furnished with our very fine Orto-line nude diamond stylus. It has exceptionally long contact with the groove wall as a result of its large radius of 100  $\mu\text{m}$ . The slim profile of this superbly finished stylus ensures a wide contact area for the effortless, accurate retrieval of the subtle details so essential to the realism of home music reproduction.

## The moving system

The stylus is mounted in a lightweight tapered aluminium cantilever which in combination with the very stiff carbon fibre armature combines the best components for reproducing even the finest modulations from the record groove.

In this cartridge we are also proud to present the latest technology in super pure materials by using a silver wire for the armature windings of 99.9999% pure silver, also called 6-Nines.

In order to improve the signal to noise ratio when using this cartridge with a wide range of amplifiers having MC input, the new Rohmann cartridge has a very high output of 250  $\mu\text{Volt}$ . This high output has been achieved mainly by concentrating the very high magnetic energy from the Neodymium magnet in a more efficient way around the armature.

## The housing

It will be recognised that the housing for this cartridge is based on the same design as the one used for our anniversary cartridge MC 7500. This time however the cartridge body has been milled out of a solid aluminium block. A precision process ensuring perfect mechanical matching of the individual components in the magnetic system.

The total weight of the system has been reduced by 2 gram to just 9 gram. This has a positive influence on the tonearm resonance, when matching this cartridge with rather heavy tonearms.

The surface of the cartridge has been given an appealing yet hard and very resistant anodizing treatment which is royal blue in colour.

## The sound

How will the development of the above mentioned features influence the sound? We have of course made our own judgement and we feel that it is really special. However, we would rather like you to refer to the number of very esteemed analogue reviewers who write about a big and warm sound with a dynamic but well balanced intermediate and high response.

The true Ortofon moving coil sound!

## Amplifier compatibility

As mentioned the Rohmann cartridge will have no problems matching amplifiers with MC input sockets.

For customers having MM input only, we can recommend our T 3000 or T 20 II transformers as an equal alternative.

Rohmann Cartridge

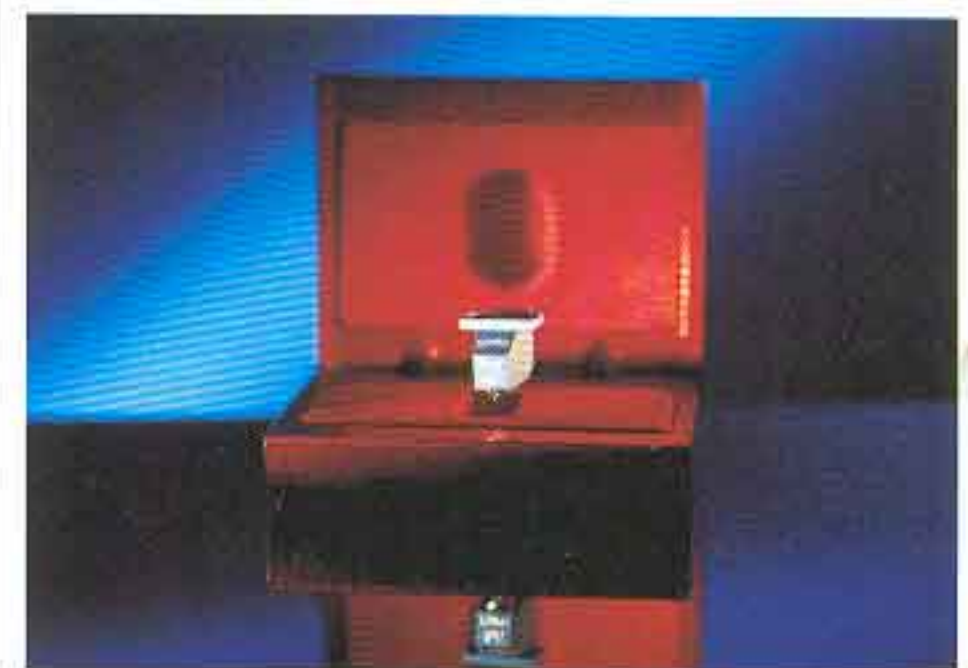
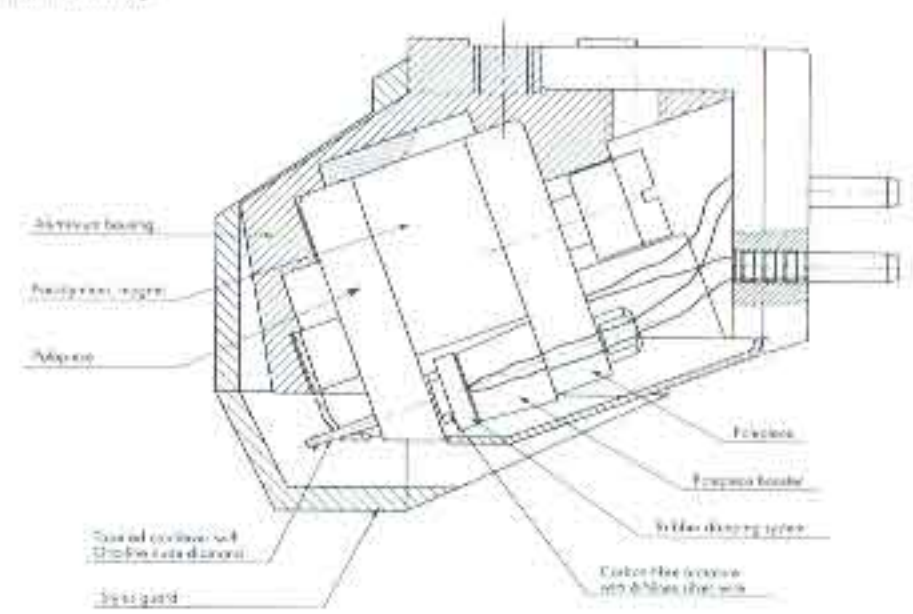

## Specification:

Output voltage at 1000 Hz, 5cm/sec.	250 $\mu\text{Volt}$
Channel balance at 1000Hz	<1,5 dB
Channel separation at 1000 Hz	>25 dB
Channel separation at 15,000 Hz	>15 dB
Frequency range	20-55,000 Hz
Amplitude response	20-20,000 Hz $\pm 2$ dB
FIM distortion at recommended tracking force DIN 45.542	<1%
Tracking ability at 315 Hz at recommended tracking force	80 $\mu\text{m}$
Dynamic compliance, lateral Stylus (diamond shape)	12 $\mu\text{m}/\text{mN}$
Stylus tip radius	"Orto-Line"
Equivalent stylus tip mass	r/R=4.5/100 $\mu\text{m}$
Recommended tracking force	0.25 mg
Cartridge body material	25 mN/2.5 gram
Weight	Aluminium, milled out of solid block
Internal impedance DC resistance	9 gram
Recommended load impedance	6 ohm
Vertical tracking angle	10-100 ohm
	20°